

New Household Hazardous Waste Collection Site



Boise's mobile household hazardous waste collection vehicle—the "EnviroGuard" truck.

Location: Cole/Ustick Library

Starting in September, a new collection site will be added to the award-winning Household Hazardous Waste Collection program. Co-located in the parking lot of the Cole/Ustick Library, the new site will be open the **2nd Tuesday of each month** from NOON to 7 PM with the first day of collection on Tuesday, September 8th. Items such as paint, solvents, automotive products, lawn and garden chemicals, fluorescent light bulbs, and household chemicals will be accepted. Please do NOT leave items in the parking lot. For more information and a complete schedule of all collection sites, visit www.curbitboise.org and select the Household Hazardous Waste tab or call 384-3901.

"Recycle the Fall" Leaf Collection

Autumn is quickly approaching and you have multiple options when it comes to managing fall leaves and grass under Boise's new Curb It program. As you rake and sweep your leaves, please note the following guidelines:

Fall Leaf & Grass Options

- **Compost at home**—If you are new to composting, compost bins and instructions are available at Boise City Hall (150 N. Capitol Boulevard, 4th floor) for \$59 plus sales tax.
- **Curbside collection in paper leaf bags**—Boise provides five weeks of curbside leaf collection: Nov. 2—Dec. 4, 2009. Separate the leaf bags from your trash on your regular service day. A truck marked with a "Leaf Recycling" sign will collect them by 9 p.m.
- **Trash Cart**—Leaves are always accepted as trash.
- **Do not put leaves or yard waste in the blue recycling cart.**



Watch for your "Recycle the Fall" Leaf Bag Coupon in the Mail

Important Dates

- **Nov.2—Dec.4:** Curbside collection of leaves for composting (in paper leaf bags).
- **Oct.19—Dec.18:** Allied Waste Transfer Station (S. Orchard near Boise Airport) will accept leaves for composting at no charge.
- **Oct.26—Dec.19:** Ada County Landfill (Seaman's Gulch Rd.) will accept leaves for composting at no charge.
- **If your service day falls on or after Thanksgiving, your service will be delayed by one day.**





Free Cart Exchange: September & October 2009

If you would like to exchange your current trash or recycling cart for another size (48, 65 or 95-gallon options) please contact Allied Waste at 345-1266 and our customer service representatives will schedule a cart exchange at no charge during September & October. After Oct.31, there will be a fee to increase your cart size or add carts.

Question? Contact Allied Waste:
208.345.1266
www.alliedwasteidaho.com
rklein@republicservices.com



Did You Know Your New Carts are "Married" ?

More than 130,000 trash and recycling carts were delivered during the roll-out of Boise's new Curb It program. Each of these carts has a microchip in the handle that has been electronically assigned or "married" to your address. It is important that the carts stay at this location. Please do not relocate the carts if you move.

Boise City offers "Cart-to-the-Curb" Program

The new carts have their advantages: they block rainwater, contain odors, prevent animal tampering, and help protect your drivers from harm. They are, however, larger than traditional trash cans and recycling bins, and can be hard to move for some residents.

If you have difficulty getting your cart(s) to the curb, the city of Boise has a free program that can

Cart Placement

KEEP CARTS AT LEAST 3 FEET AWAY FROM:

Mailboxes - Other Carts - Parked Cars
Fire Hydrants - Utility Poles

KEEP CARTS AT LEAST 14 FEET AWAY FROM:

Low Hanging Trees or Shrubs

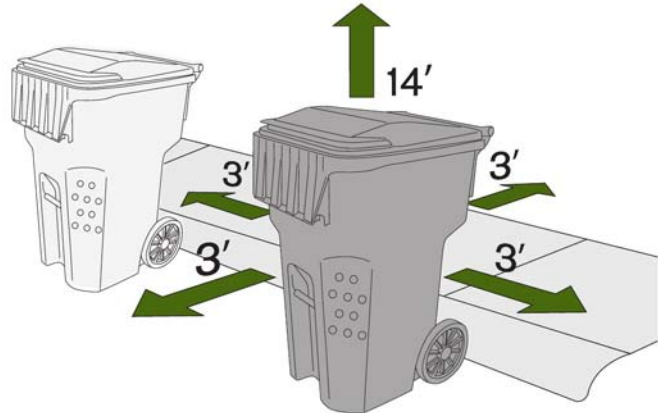

Questions? Call 345-1266
www.curbitboise.org



help. Boise's new "Cart-to-the Curb" program connects high school honor students with Boise residents for a short one-time meeting. The students will show residents how to move and store carts easily.

We have eager students waiting to help, so call Boise City Public Works (384-3903) to take advantage of this service.